

# TECHNICAL DATA SHEET



Product Name	BLD SENSOR	Part Number	2508290-25
Apply To	TEMPERATURE MEASUREMENT SYSTEM	Document No.	DS-L001A-EN



## DESCRIPTION

The digital BLD sensor collects the internal furnace noise at the sound guide tube and controls the on/off operation of the solenoid valve to perform soot blowing on the sound guide tube.



## MECHANICAL

Material Body	Aluminum alloy
Sensor Mount	Flanged
communication	RJ45
Protection Degree	IP65



## FUNCTIONAL

Accuracy	16-bit
Sampling Rate (Single Channel)	44.1KHz
Full-Channel Synchronous Acquisition	Supported(100ms)
Sensitivity	50 mV/Pa
Frequency Response Range	20Hz to 20kHz
Power Supply	48V
Output	Digital signal
Ambient Temperature	-20°C to +80°C





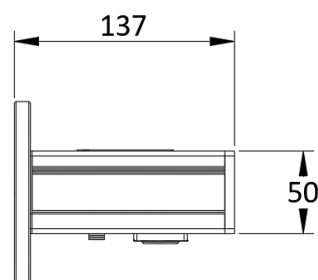
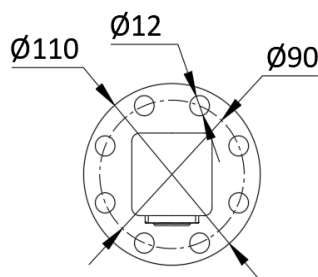

## DIMENSIONS



# TECHNICAL DATA SHEET

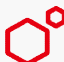

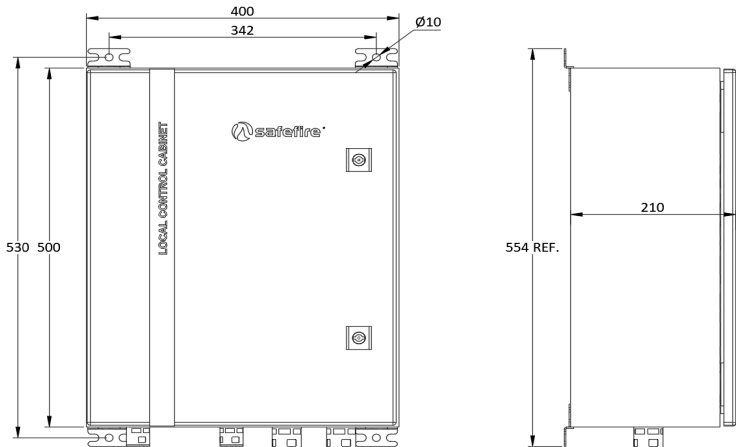
Product Name	MASTER LOCAL CONTROL CABINET	Part Number	2508290-28
Apply To	BOILER TUBE LEAK DETECTION SYSTEM	Document No.	DS-L002A-EN
<div> DESCRIPTION</div>	<p>The master local control cabinet collects signals from all local control cabinets and transmits them centrally to the main control cabinet. It also provides power to the BLD sensors within its designated area and receives the acoustic signals collected by these sensors.</p>		
<div> ENCLOSURE</div>	Type	Wall-mount	
	Material	304 SST	
	Finish	Brushed	
	Protection Degree	IP65	
	Dimention(HxWxD)	500x400x210mm	
<div> ELECTRICAL</div>	Power Input	100-240Vac, 50-60Hz	
	Power Output	48Vdc	
	Communication	Ethernet, Cat 6	
		Optic Fiber, SFP	
	Transmitter	Optic Fiber Termination Box	
<div> DIMENSIONS</div>			

# TECHNICAL DATA SHEET



Product Name	LOCAL CONTROL CABINET	Part Number	2508290-29
Apply To	BOILER TUBE LEAK DETECTION SYSTEM	Document No.	DS-L003A-EN



## DESCRIPTION

The local control cabinet is the hub station connecting the BLD sensors to the main control cabinet. It provides power the BLD sensors and enables them to be monitored and controlled. It also transmits the acoustic signals by the sensors to the main control cabinet in real time.



## ENCLOSURE

Type	Wall-mount
Material	304 SST
Finish	Brushed
Protection Degree	IP65
Dimention(HxWxD)	300x380x210mm



## ELECTRICAL

Power Input	100-240Vac, 50-60Hz
Power Output	48Vdc
Communication	Ethernet, Cat 6
Transmitter	Network Switch



## DIMENSIONS

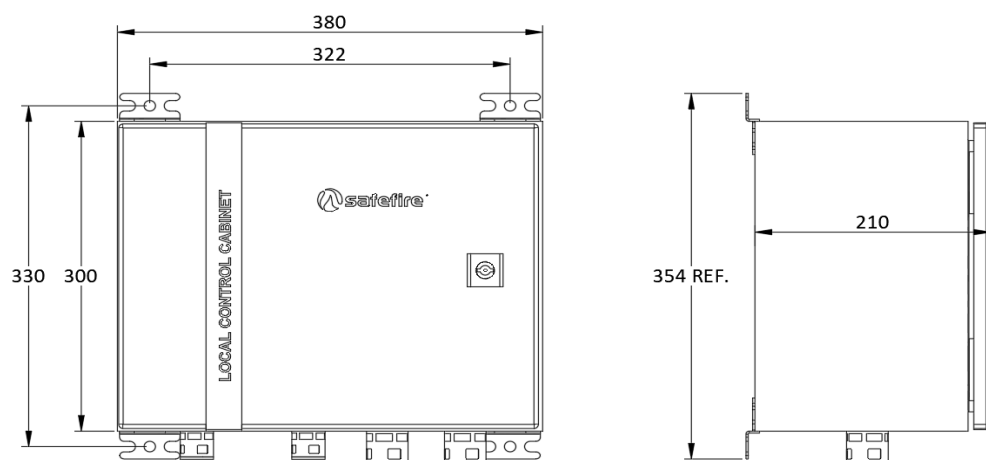

# TECHNICAL DATA SHEET



Product Name	MAIN CONTROL CABIENT	Part Number	2508290-27
Apply To	BOILER TUBE LEAK DETECTION SYSTEM	Document No.	DS-L004A-EN
<div></div> <div>DESCRIPTION</div>	<p>In main control cabinet, monitoring signals, steam flow input signal, boiler soot blowing switch signal, sent to monitoring host in the cabinet together, unified signal processing, then send to the industrial control computer. Industrial Control Computer should be equipped with appropriate hardware interface, in order to be merged into the DCS, DAS, MIS, SIS, realize the necessary remote technical support.</p>		
<div></div> <div>ENCLOSURE</div>	Type	Floor-standing	
	Material	Carbon Steel	
	Finish	Powder-coated, RAL7035	
	Protection Degree	IP54	
	Dimention(HxWxD)	2200x800x600mm	
<div></div> <div>SOFTWARE</div>	Feature	Parameter Settings	
		Spectrum Analysis	
		Historical Curve	
		Historical Spectrum	
		Record Query	
		Ash leaning Control	
		Historical Spectrum	
<div></div> <div>COMPONENTS</div>	Industrial Control Computer	IPC-7120	
	Monitor	24", 1920x1080, Touch Screen	
	DCS Module	2DC+2DI+2AI(4-20mA), RS485/ RJ45	
	Network Switch	4-RJ45&2-SFP	
<div></div> <div>DIMENSIONS</div>			